

Specification

A 3-way pneumatic ball valve is a type of valve that controls the flow of fluid or gas through a system using compressed air or gas. It consists of a spherical ball with a hole through its center, which can be rotated to either allow or block the flow of the fluid or directions depending on the position of the ball.

These valves are commonly used in various industrial applications where precise control of fluid or gas flow is required, such as in process control systems, water treatment plants, chemical processing plants, and pneumatic systems. The pneumatic actuator attached to the valve allows for remote operation, making it suitable for use in automated systems where manual operation is not feasible or practical.

Applications of 3-Way Pneumatic Ball Valve:

Water Treatment Plants:

3-way pneumatic ball valves are utilized in water treatment plants to regulate the flow of water between different treatment stages, such as filtration, disinfection, and distribution. They help maintain optimal water quality and ensure efficient operation of the treatment process.

Pneumatic Systems:

3-way pneumatic ball valves are integral components of pneumatic systems, where they control the flow of compressed air or gases to actuate various pneumatic actuators, cylinders, and other devices. They enable the automation of equipment and machinery in manufacturing and industrial environments.

Hydraulic Systems:

In hydraulic systems, 3-way pneumatic ball valves control the flow of hydraulic fluid between different components, such as cylinders, motors, and control valves. They ensure precise operation and control of hydraulic equipment in various industrial and mobile applications.

As a professional 3 Way Ball Valve Manufacturers providing high quality Pneumatic 3-Way Ball Valve, please contact us.



Pneumatic 3-Way Ball Valve

Features

- Nominal pressure : PN 1.6,2.5,4.0,6.4MPa
- Strength test pressure: PT 2.4,3.8,6.0, 9.6MPa
- Sealed test pressure (low pressure): 0.6MPa
- Seal test pressure (pressure): 1.8,2.8,4.4, -7.1M pa
- Suitable medium: Suitable medium: water, oil, gas, nitric acid, acetic acid
- Suitable temperature: PTFE : -20 °C ~ +150 °C
PPL: -20 °C ~ +200 °C

(WCB, CF8, CF8M/I, Ti, Ni)

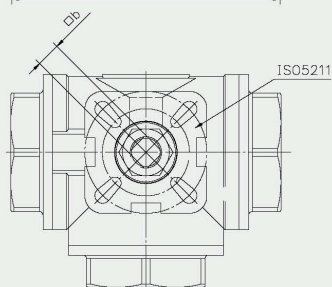
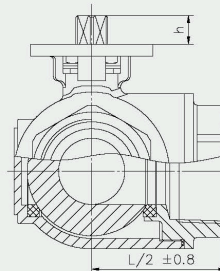
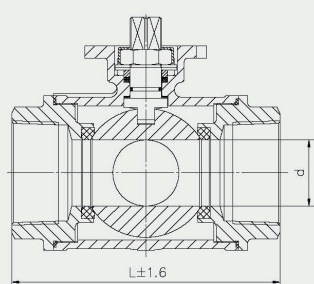

MODEL	INCH	DN	d	L	h	b	ISO5211	ACTUATOR
RBVP14-15	1/2"	15	12	72	8.5	9	F03/F04	RAT052DA
RBVP14-20	3/4"	20	15	82	9.5	9	F03/F04	RAT052DA
RBVP14-25	1"	25	18	90	11	11	F04/F05	RAT052DA
RBVP14-32	1-1/4"	32	25	128	12	11	F04/F05	RAT063DA
RBVP14-40	1-1/2"	40	32	137	16.5	14	F05/F07	RAT075DA
RBVP14-50	2"	50	38	154	16.5	14	F05/F07	RAT083DA
RBVP14-65	2-1/2"	65	48	185	20	17	F07/F10	RAT092DA
RBVP14-80	3"	80	55	212	20	17	F07/F10	RAT105DA
RBVP14-100	4"	100	74	254	22.5	19	F07/F10	RAT125DA