

DPS-2 Series

PANEL

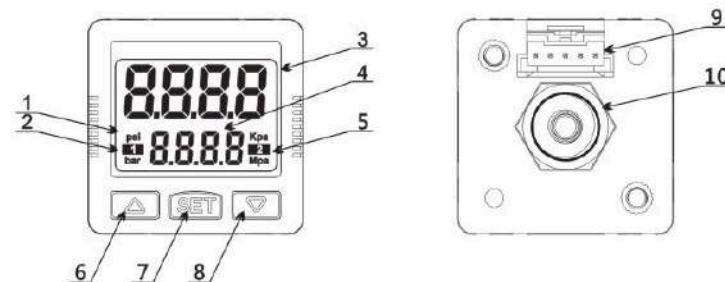

No	Name
1	Pressure Unit
2	Output 1 Indicator
3	Main Display Section
4	Sub-display Section
5	Output 2 Indicator
6	Up Button
7	Setting Button
8	Down Button
9	Electric Interface
10	Pressure Port

SPECIFICATION

Model		DPS-201(Compound)	DPS-210(Positive)
Pressure measure	Range Of Measure	-100kPa~100kPa	-0.100MPa~1.000MPa
	Setting Range	-100kPa~100kPa	0.000MPa~1.000MPa
	Withstand Pressure	500kPa	1.500MPa
	Pressure Type	Non-flammable ,Non-corrosive gas, Gauge pressure measurement	
	Measure Accuracy	≤±2%F.S.(Ambient temperature 25°C)	
	Temperature Error	≤±3%F.S. (Temperature range 0~ 50°C)	
	Measure Pattern	Hysteresis model Compare mode of upper and lower bounds	
Port size		External R1/8, NPT1/8, G1/8 option , internal thread M5	
Display	Brief Description	Double LCD display	
	Status Display	4-digital measurement value ,unit display,output status display	
	Display Model	Adjustable backlight ,4 groups of display models	
Input Power	Voltage Range	12~24vdc ±10%	
	Power Consumption	40mA MAX(Non-load)	
Output Signal	Transistor Output	NPN open-collector oupt Output current :80mA MAX Voltage drop : <1V	PNP open-collector oupt Output current :80mA MAX Voltage drop : <1V
	Analog Output	Voltage output Signal amplitude:1~5V Load resistance >1 kΩ	Current output Signal amplitude:4~20mA Load resistance<400Ω
	Response Time	Adjustable : 2.5ms, 20ms, 100ms, 500ms, 1000ms, 1500ms	
	Short-circuit Protection	Yes	
Environmental Resistance	Ip Class	IP40	
	Ambient Temperature	Operating temperature 0~50°C , storage temperature -20~60°C	
	Ambient Humidity	Operating humidity 35~ 80%RH	
	Insulation Voltage	1000VAC 1min	
	Insulation Resistance	≥ 500mΩ(500VDC)	
	Shock	Max100m/s²,3time seach in 6 directions of x,y,z	
	Vibration	A mplitude 1.5mm, 10HZ~ 500HZ, 2 hours each direction of x,y,z	

ORDERING CODE

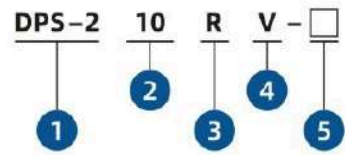

1. DPS-2 Series

2. Range
 10: -100~1000kpa
 01: -100~100kpa

3. Port
 R: R1/8(M5 female thread)
 N: NPT1/8 (M5 female thread)
 G: G1/8 (M5 female thread)

4. Output

N: NPNx2
 P: PNPx2
 A: NPN+Analog 4~20mA
 V: NPN+Analog 1~5V
 B: PNP+Analog 4~20mA
 W: PNP+Analog 1~5V

5. Mounting

M: Panel
 N: Panel+shield
 Z: L bracket
 S: S bracket

QUICK SETTING

Zero point setting



In the measure mode, press + [▲] [▼] button at the same time, until display "0", release the button;
 PS: reset range: +/-10%F.S.

key lock and unlock

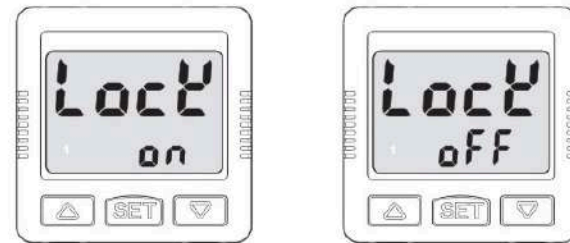

Lock: in the measure mode, press [▲] + [SET] + [▼] button at the same time until "LOCK ON" shown, release the buttons;
 Unlock: in the measure mode, press [▲] + [SET] + [▼] button at the same time until "LOCK OFF" shown, release the buttons.

Easy setup

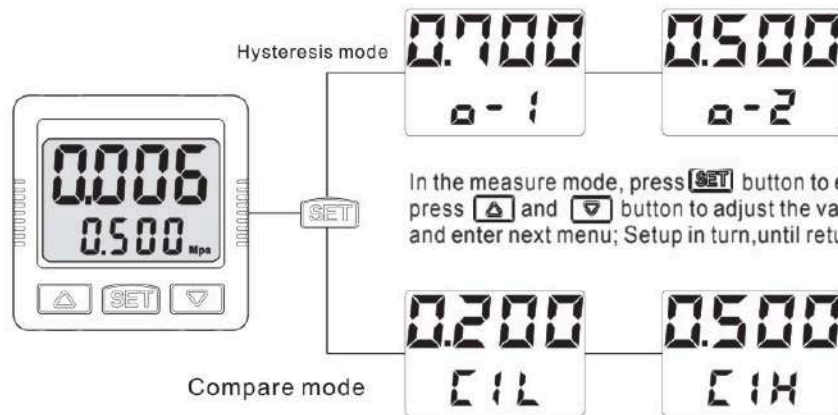

In the measure mode, press [SET] button to enter easy setting mode, press [▲] and [▼] button to adjust the value; press [SET] button and enter next menu; Setup in turn, until return to measurement interface.

MOUNTING DIMENSIONS(mm)

Mounting dimensions(mm)

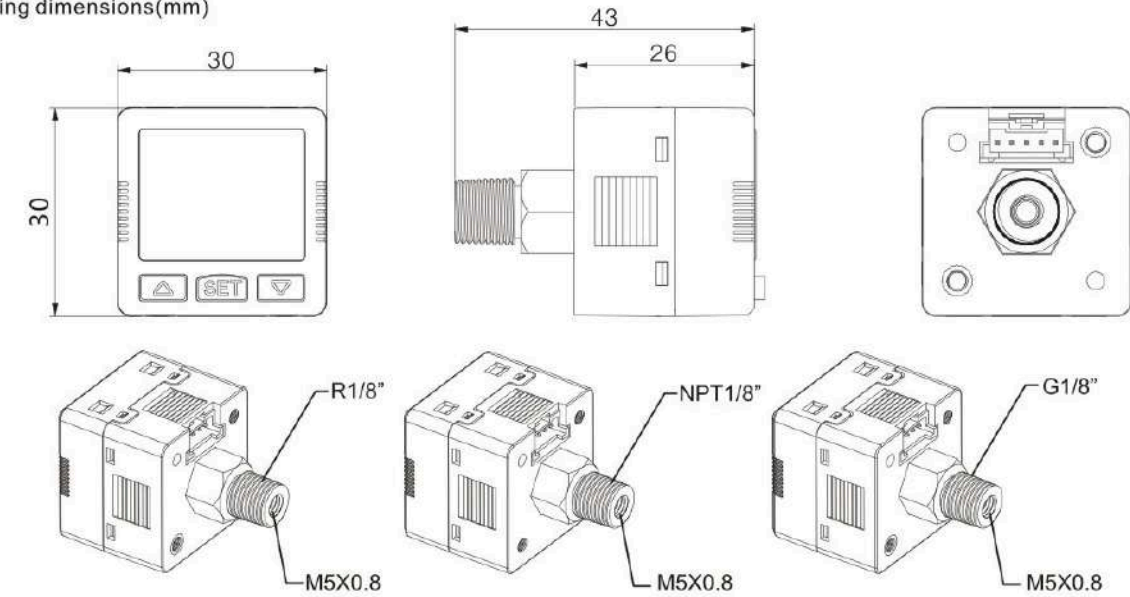

Mounting Bracket

L bracket

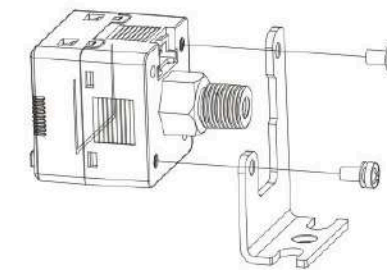

S bracket

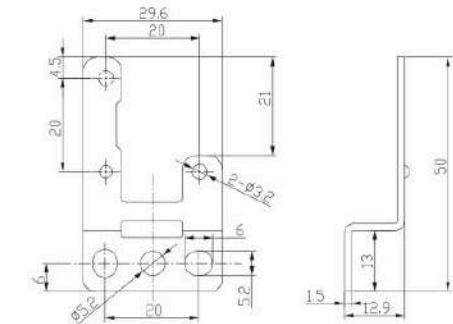
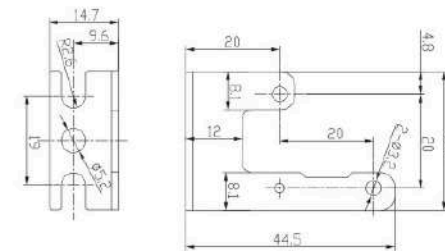
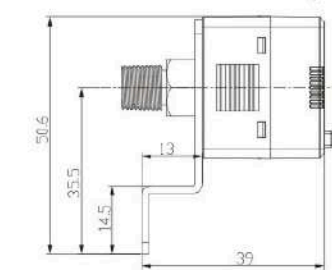
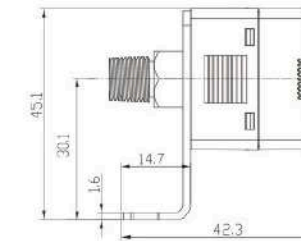
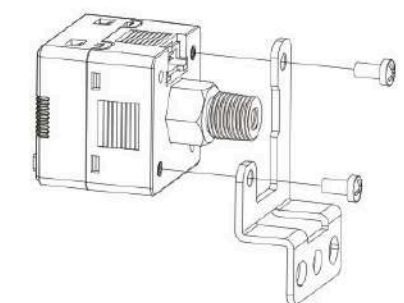

Panel bracket

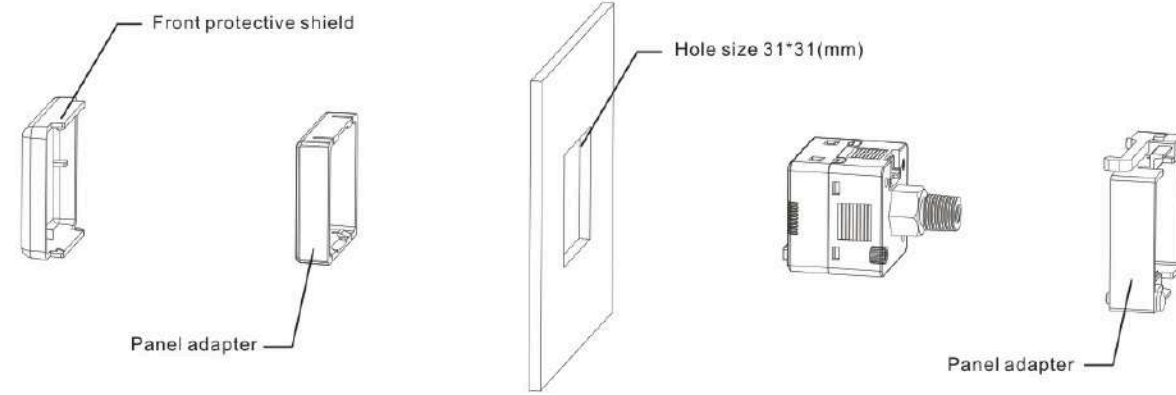

Panel mount

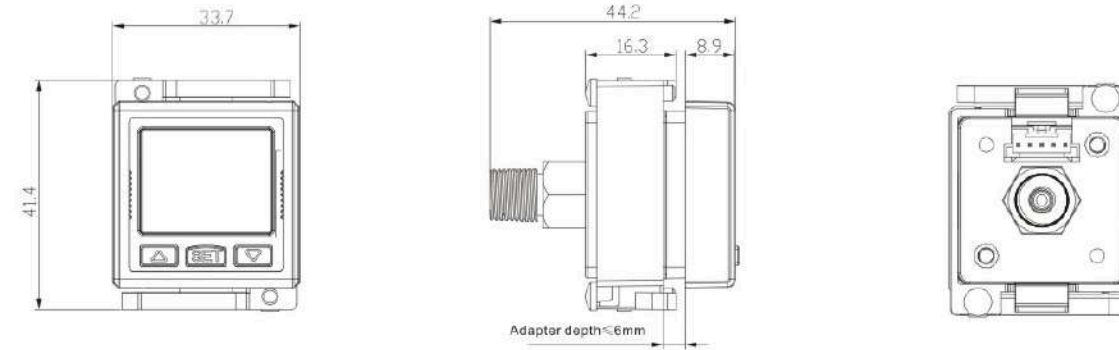

Add dust cover installation

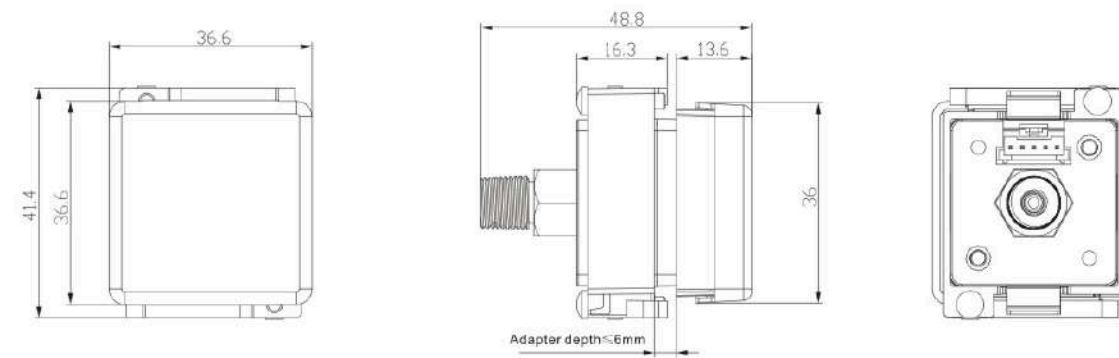

Wire dimension

