

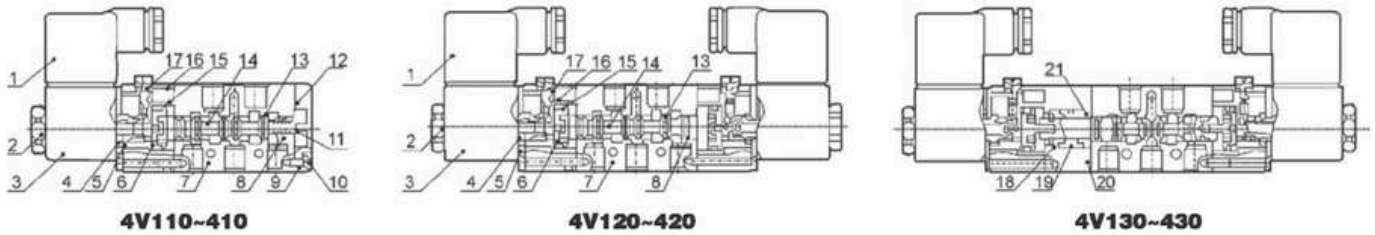

**Ordering Code**

<b>4V</b>	<b>2</b>	<b>10</b>	—	<b>06</b>	□	—	<b>AC220V</b>	—	<b>W</b>
<b>Specification Code</b> 4V:Two(Three)-position Five-way Solenoid Valve 4A:Two(Three)-position Five-way Pneumatic Control Valve	<b>Body Size</b> 1:M5 and 1/8" Valve body 2:1/8" and 1/4" Valve body 3:1/4" and 3/8" Valve body 4:1/2" Valve body	<b>Coil and Places</b> 10:Single-head Double-position 20:Double-head Double-position 30C:Double-head Three-position Close Type 30E:Double-head Three-position Exhaust Type 30P:Double-head Three-position Pressure Type		<b>Port Size</b> M5:M5×0.8 06:G1/8" 08:G1/4" 10:G3/8" 15:G2"	<b>Port connection and Initial State</b> Blank:Pipe Connection Type NC:Two-position Three-way Normal Close Type NO:Two-position Three-way Normal Open Type		<b>Standard Voltage</b> DC12V DC24V AC24V 50Hz/60Hz AC110V 50Hz/60Hz AC220V 50Hz/60Hz AC380V 50Hz/60Hz		<b>Wiring Form</b> Blank:standard Connector LD:Brown with Lighting Connector LD1:White with Lighting Connector W:Lead Wire Type

**Internal structure**



NO	Designation	NO	Designation	NO	Designation	NO	Designation	NO	Designation	NO	Designation	NO	Designation
1	Connector	4	Active Amature	7	Body	10	Screw	13	O-Ring	16	Spring	19	Spring
2	Nut	5	Steel Part	8	Wearing	11	Spring	14	Spool	17	Pin	20	Side Cover
3	Coil	6	Piston	9	End Cap	12	Seal ring	15	O-Ring	18	Spring Seat	21	Spring Seat

**Specification**

Model	4V110~410	4V120~420	4V130~430C/P/E
Position and Way NO.	4A110~410	4A120~420	4A130~430C/P/E
Working Medium	Two-position Five-way		Three-position Five-way
Motion Pattern	40 Micron Filtered Air		
Working-Pressure	Inner Guide Type		
Max.Pressure Resistance	0.15~0.8MPa		
Operating Temperature	1.2MPa		
Voltage Range	5~50℃		
Power Consumption	±10%		
Insulation & Protection Class	AC:4.5VA DC:3W		
Electrical entry	F Class.IP65		
Highest Action Frequency	Lead Wire or Connector type		
Response time	5 Cycle / Second		
	0.05 Second		

**Overall Dimensions**

**4V110-410**

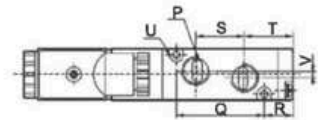
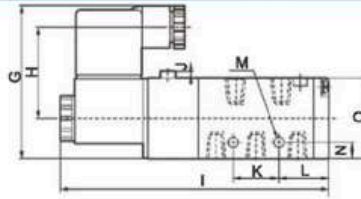
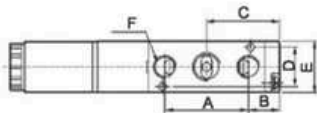

**Dimension Sheet**

Model	A	B	C	D	E	F	G	H	I	J	K	L	M	N	O	P	Q	R	S	T	U	V	
4V110-M5	27	14.5	28	13	18	5-M5×0.8	53.5	32.5	98	2.5	14	21	2-φ3.3	4	27	2-φ3.3	30	13	14	21	/	/	
4V110-06	28	14	28	13	18	5-G1/8"	53.5	32.5	98	2.5	14	21	2-φ3.3	4	27	2-φ3.3	30	13	14	21	2	3	
4V210-06	36	13.5	31.5	17	22	5-G1/8"	66.5	40	116.5	3	20	21.5	2-φ4.3	7	35	2-φ3.3	38	12.5	18	22.5	/	/	
4V210-08	36	13.5	31.5	17	22	2-G1/4"	66.5	40	116.5	3	20	21.5	2-φ4.3	7	35	2-φ3.3	38	12.5	18	22.53-G1/4"	/	3	
4V310-08	45	17.5	40	20	27	5-G1/4"	69	40	134.5	2.4	24	28	2-φ4.3	6.5	40	2-φ4.3	50	15	22	29	/	/	
4V310-10	45	17.5	40	20	27	2-G3/8"	69	40	134.5	2.4	24	28	2-φ4.3	6.5	40	2-φ4.3	50	15	24	28	3-G3/8"	/	4
4V410-15	63	25.5	57	27	34	5-G1/2"	74	/	168	/	28	43	2-φ5.5	7.5	50	2-φ4.3	72	21	36	39	/	4	

**Overall Dimensions**

**4V120-420**

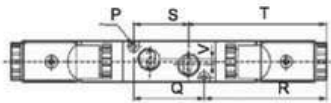
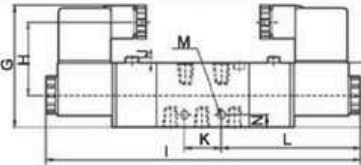
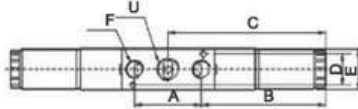

**Dimension Sheet**

Model	A	B	C	D	E	F	G	H	I	J	K	L	M	N	O	P	Q	R	S	T	U	V
4V120-M5	27	56.3	69.8	13	18	5-M5×0.8	53.5	32.5	139.6	2.5	14	62.8	2-φ3.3	4	27	2-φ3.3	30	54.8	14.1	62.8	/	/
4V120-06	28	56	69.8	13	18	5-G1/8"	53.5	32.5	139.6	2.5	14	62.8	2-φ3.3	4	27	2-φ3.3	30	54.8	16	62.8	2	3
4V220-06	36	67	85	17	22	5-G1/8"	66.5	40	169.8	3	20	75	2-φ4.3	7	35	2-φ3	38	66	18	76	/	/
4V220-08	36	67	85	17	22	2-G1/4"	66.5	40	169.8	3	20	75	2-φ4.3	7	35	2-φ3.2	38	66	21	74.43-G1/4"	/	3
4V320-08	45	71.9	94.4	20	27	5-G1/4"	69	40	188.8	2.4	24	82.4	2-φ4.3	6.5	40	2-φ4.3	50	69.4	22	83.4	/	/
4V320-10	45	71.9	94.4	20	27	2-G3/8"	69	40	188.8	2.4	24	82.4	2-φ4.3	6.5	40	2-φ4.3	50	69.4	24	82.43-G3/8"	/	4
4V420-15	63	79.5	111	27	34	5-G1/2"	74	/	/	/	28	97	2-φ5.5	7.5	50	2-φ4.3	72	75	36	93	/	4

**Overall Dimensions**

**4V130~430C/P/E**

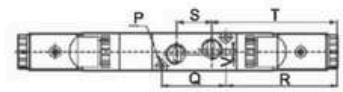
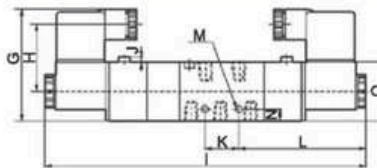
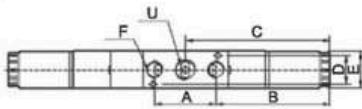
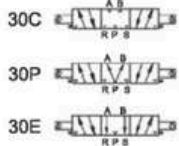

**Dimension Sheet**

Model	A	B	C	D	E	F	G	H	I	J	K	L	M	N	O	P	Q	R	S	T	U	V
4V130-M5	27	56.3	69.8	13	18	5-M5×0.8	53.5	32.5	154.6	2.5	14	62.8	2-φ3.3	4	27	2-φ3.3	30	54.8	14	62.8	/	/
4V130-06	28	56	69.8	13	18	5-G1/8"	53.5	32.5	154.6	2.5	14	62.8	2-φ3.3	4	27	2-φ3.3	30	54.8	16	62	2	3
4V230-06	36	67	84.9	17	22	5-G1/8"	66.5	40	189	3	20	75	2-φ4.3	7	35	2-φ3.2	38	65.9	18	75.9	/	/
4V230-08	36	67	84.9	17	22	2-G1/4"	66.5	40	189	3	20	75	2-φ4.3	7	35	2-φ3.2	38	65.9	21	74.43-G1/4"	/	3
4V330-08	45	71.9	94.4	20	27	5-G1/4"	69	40	208	2.4	24	82.4	2-φ4.3	6.5	40	2-φ4.3	50	69.4	22	83.4	/	/
4V330-10	45	71.9	94.4	20	27	2-G3/8"	69	40	207.8	2.4	24	82.4	2-φ4.3	6.5	40	2-φ4.3	50	69.4	24	82.43-G3/8"	/	4
4V430-15	63	79.5	111	27	34	5-G1/2"	74	/	/	/	28	97	2-φ5.5	7.5	50	2-φ4.3	72	75	36	93	/	4



**Overall Dimensions**

**4A110-410**

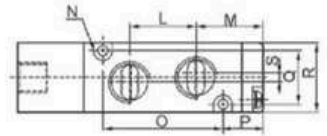
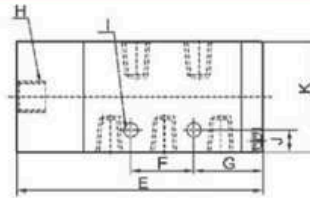
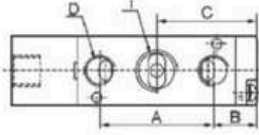

**Dimension Sheet**

Model	A	B	C	D	E	F	G	H	I	J	K	L	M	N	O	P	Q	R	S	T
4A110-M5	27	14.5	28	5-M5×0.8	68.7	14	21	G1/8"	2-φ3.3	4	27	30	13	2-φ3.3	21	14	13	18	/	/
4A110-06	28	14.2	28.2	5-G1/8"	68.7	14	21	G1/8"	2-φ3.3	4	27	30	13	2-φ3.3	20.2	16	13	18	3	2
4A210-06	36	13.5	31.5	5-G1/8"	77.7	20	21.5	G1/8"	2-φ4.3	7	35	38	12.5	2-φ3.2	22.5	18	17	22	/	/
4A210-08	36	13.5	31.7	2-G1/4"	77.7	20	21.5	G1/8"	2-φ4.3	7	35	38	12.5	2-φ3.2	21	21	17	22	3	3-G1/4"
4A310-08	45	17.5	40	5-G1/4"	95.5	24	28	G1/8"	2-φ4.3	6.5	40	50	15	2-φ4.3	29	22	20	27	/	/
4A310-10	45	17.5	40	2-G3/8"	95.5	24	28	G1/8"	2-φ4.3	6.5	40	50	15	2-φ4.3	28	24	20	27	4	3-G3/8"
4A410-15	63	25.5	57	5-G1/2"	128	28	43	G1/8"	2-φ5.5	7.5	50	72	21	2-φ4.3	39	36	27	34	4	/

**Overall Dimensions**

**4A120-420**

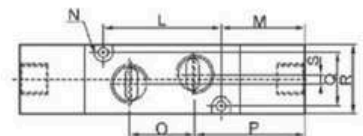
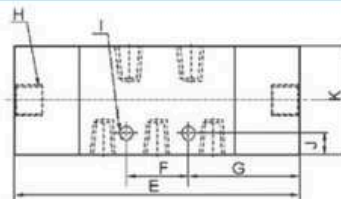
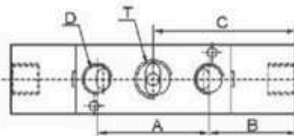

**Dimension Sheet**

Model	A	B	C	D	E	F	G	H	I	J	K	L	M	N	O	P	Q	R	S	T
4A120-M5	27	27	40.5	5-M5×0.8	81	14	33.5	2-G1/8"	2-φ3.3	4	27	30	25.5	2-φ3.3	21	33.5	13	18	/	/
4A120-06	28	26.5	40.5	5-G1/8"	81	14	33.5	2-G1/8"	2-φ3.3	4	27	30	25.5	2-φ3.3	20.2	32.5	13	18	3	2
4A220-06	36	28	46	5-G1/8"	92	20	36	2-G1/8"	2-φ4.3	7	35	38	27	2-φ3.2	22.5	37	17	22	/	/
4A220-08	36	28	46	2-G1/4"	92	20	36	2-G1/8"	2-φ4.3	7	35	38	27	2-φ3.2	21	35.5	17	22	3	3-G1/4"
4A320-08	45	33	55.5	5-G1/4"	111	24	43.5	2-G1/8"	2-φ4.3	6.5	40	50	30.5	2-φ4.3	29	44.5	20	27	/	/
4A320-10	45	33	55.5	2-G3/8"	111	24	43.5	2-G1/8"	2-φ4.3	6.5	40	50	30.5	2-φ4.3	28	43.5	20	27	4	3-G3/8"
4A420-15	63	39.5	71	5-G1/2"	142	28	57	2-G1/8"	2-φ5.5	7.5	50	72	35	2-φ4.3	39	53	27	34	4	/

**Overall Dimensions**

**4A130-430C/P/E**

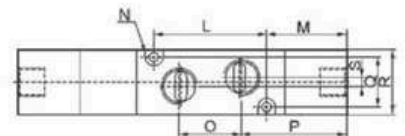
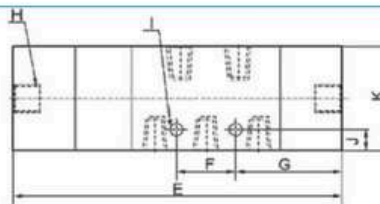
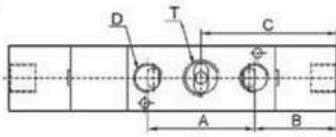
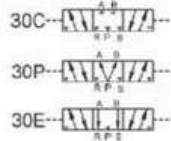

**Dimension Sheet**

Model	A	B	C	D	E	F	G	H	I	J	K	L	M	N	O	P	Q	R	S	T
4A130-M5	27	27	40.5	5-M5×0.8	96	14	33.5	2-G1/8"	2-φ3.3	4	27	30	25.5	2-φ3.3	21	33.5	13	18	/	/
4A130-06	28	26.5	40.5	5-G1/8"	96	14	33.5	2-G1/8"	2-φ3.3	4	27	30	25.5	2-φ3.3	20.2	32.5	13	18	3	2
4A230-06	36	28	46	5-G1/8"	111	20	36	2-G1/8"	2-φ4.3	7	35	38	27	2-φ3.2	22.5	37	17	22	/	/
4A230-08	36	28	46	2-G1/4"	111	20	36	2-G1/8"	2-φ4.3	7	35	38	27	2-φ3.2	21	35.5	17	22	3	3-G1/4"
4A330-08	45	33	55.5	5-G1/4"	130	24	43.5	2-G1/8"	2-φ4.3	6.5	40	50	30.5	2-φ4.3	29	44.5	20	27	/	/
4A330-10	45	33	55.5	2-G3/8"	130	24	43.5	2-G1/8"	2-φ4.3	6.5	40	50	30.5	2-φ4.3	28	43.5	20	27	4	3-G3/8"
4A430-15	63	39.5	71	5-G1/2"	142	28	57	2-G1/8"	2-φ5.5	7.5	50	72	35	2-φ4.3	39	53	27	34	4	/



3V120-06



3V110-06



3A210-08



3V420-15



3A420-15

**Ordering Code**

**3V**

**2**

**10**

**06**



**AC220V**

**W**

**Specification Code**

3V: Two-position Three-way Solenoid Valve  
 3A: Two-position Three-way Pneumatic Control Valve

**Body Size**

1: M5 and 1/8" Valve body  
 2: 1/8" and 1/4" Valve body  
 3: 1/4" and 3/8" Valve body  
 4: 1/2" Valve body

**Coil and Places**

10: Single-head Double-position  
 20: Double-head Double-position  
 30C: Double-head Three-position Close Type  
 30E: Double-head Three-position Exhaust Type  
 30P: Double-head Three-position Pressure Type

**Port Size**

M5: M5×0.8  
 06: G1/8"  
 08: G1/4"  
 10: G3/8"  
 15: G2"

**Port connection and Initial State**

Blank: Pipe Connection Type  
 NC: Two-position Three-way Normal Close Type  
 NO: Two-position Three-way Normal Open Type

**Standard Voltage**

DC12V  
 DC24V  
 AC24V 50Hz/60Hz  
 AC110V 50Hz/60Hz  
 AC220V 50Hz/60Hz  
 AC380V 50Hz/60Hz

**Wiring Form**

Blank: standard Connector  
 LD: Brown with Lighting Connector  
 LD1: White with Lighting Connector  
 W: Lead Wire Type

**Internal structure**

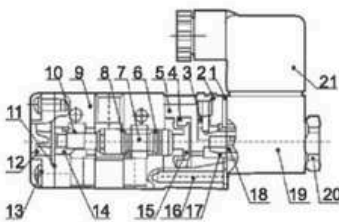

3V110-410

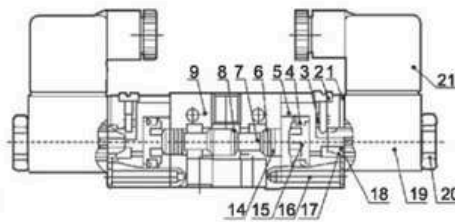

3V120-420

NO	Designation	NO	Designation	NO	Designation
1	Washer	8	O-Ring	15	Piston
2	Pin	9	Body	16	Screw
3	Spring	10	Spring	17	O-Ring
4	O-Ring	11	Seal	18	Active Amature
5	Body	12	End Cap	19	Coil
6	O-Ring	13	Screw	20	Nut
7	Spool	14	Wearing	21	Connector

**Specification**

Model	3V110-410	3V120-420	3A110-410	3A120-420
Position and Way NO.	Two-position Three-way			
Working Medium	40 Micron Filtered Air			
Motion Pattern	Inner Guide Type			
Working-Pressure	0.15~0.8MPa			
Max.Pressure Resistance	1.2MPa			
Operating Temperature	5~50℃			
Voltage Range	±10%			
Power Consumption	AC:4.5VA DC:3W			
Insulation & Protection Class	F Class.IP65			
Electrical entry	Lead Wire or Connector type			
Highest Action Frequency	5 Cycle / Second			
Response time	0.05 Second			



**Overall Dimensions**

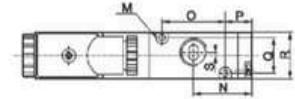
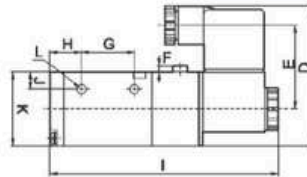
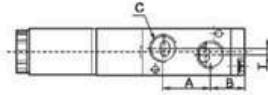
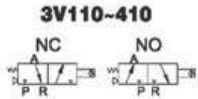

**Dimension Sheet**

Model	A	B	C	D	E	F	G	H	I	J	K	L	M	N	O	P	Q	R	S	T
3V110-M5	16	14	3-M5	53.5	32.5	2.5	21	12	85.8	7.7	27	2-φ3.3	2-φ3.3	23	19	12.5	13	18	/	/
3V110-06	16	14	3-G1/8"	53.5	32.5	2.5	21	12	85.8	7.7	27	2-φ3.3	2-φ3.3	23	19	12.5	13	18	1	2
3V210-06	18	21	3-G1/8"	66.5	40	3	25	15	111.5	8	35	2-φ3.3	2-φ3.2	31	33	12.5	17	22	1.5	/
3V210-08	18	21	3-G1/4"	66.5	40	3	25	15	111.5	8	35	2-φ3.3	2-φ3.2	31	33	12.5	17	22	1.5	3
3V310-08	24	20.5	3-G1/4"	69	40	2.4	30	17.5	119.5	10.5	40	2-φ4.3	2-φ4.3	32.5	35	15	20	27	/	/
3V310-10	24	20.5	3-G3/8"	69	40	2.4	30	17.5	119.4	10.5	40	2-φ4.3	2-φ4.3	32.5	35	15	20	27	/	/
3V410-15	31.5	25.5	3-G1/4"	74	/	/	51	15.5	137	11.5	50	2-φ4.3	2-φ4.3	41.5	/	/	/	/	2	/

**Overall Dimensions**

**3V120-420**

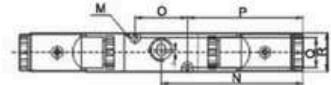
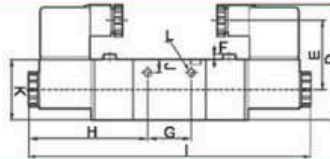
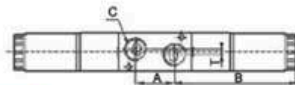

**Dimension Sheet**

Model	A	B	C	D	E	F	G	H	I	J	K	L	M	N	O	P	Q	R	S	T
3V120-M5	16	55.8	3-M5	53.5	32.5	2.5	21	53.3	127.6	7.7	27	2-φ3.3	2-φ3.3	63.8	19	54.3	13	18	/	/
3V120-06	16	55.8	3-G1/8"	53.5	32.5	2.5	21	53.3	127.6	7.7	27	2-φ3.3	2-φ3.3	63.8	19	54.5	13	18	1	2
3V220-06	18	74.5	3-G1/8"	66.5	40	3	25	68.4	165	8	35	2-φ3.3	2-φ3.2	84.5	33	66	17	22	1.5	/
3V220-08	18	74.5	3-G1/4"	66.5	40	3	25	68.4	165	8	35	2-φ3.3	2-φ3.2	84.5	33	66	17	22	1.5	3
3V320-08	24	75	3-G1/4"	69	40	2.4	30	72	174	10.5	40	2-φ4.3	2-φ4.3	87	35	69.4	20	27	/	/
3V320-10	24	75	3-G3/8"	69	40	2.4	30	72	174	10.5	40	2-φ4.3	2-φ4.3	87	35	69.4	20	27	/	/
3V420-15	31.5	79.5	3-G1/4"	74	/	/	51	/	190.5	11.5	50	2-φ4.3	2-φ4.3	95	/	/	/	/	2	/

**Overall Dimensions**

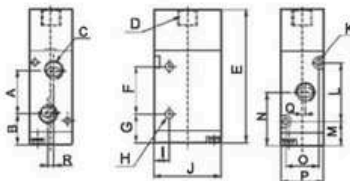
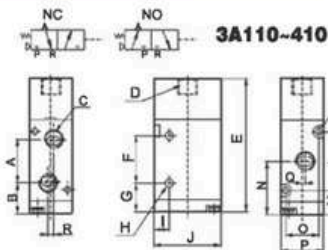

**Dimension Sheet**

Model	A	B	C	D	E	F	G	H	I	J	K	L	M	N	O	P	Q	R
3A110-M5	16	14	3-M5	G1/8"	56.5	21	11.5	2-φ3.3	7.7	27	2-φ3.3	19	12.5	23	13	18	/	/
3A110-06	16	14	3-G1/8"	G1/8"	56.5	21	11.5	2-φ3.3	7.7	27	2-φ3.3	19	12.5	23	13	18	1	2
3A210-06	22.5	16	3-G1/8"	G1/8"	70	25	15	2-φ3.3	8	35	2-φ3.3	30	12.5	27.5	17	22	1.5	/
3A210-08	22.5	16	3-G1/4"	G1/8"	70	25	15	2-φ3.3	8	35	2-φ3.3	30	12.5	27.5	17	22	1.5	3
3A310-08	24	20.5	3-G1/4"	G1/8"	80.5	30	17.5	2-φ4.3	10.5	40	2-φ4.3	35	15	32.5	20	27	/	/
3A310-10	24	20.5	3-G3/8"	G1/8"	80.5	30	17.5	2-φ4.3	10.5	40	2-φ4.3	35	15	32.5	20	27	/	/
3A410-15	31.5	25.5	3-G1/4"	G1/8"	/	51	15.5	2-φ4.3	11.5	50	2-φ4.3	/	/	41.5	27	34	2	/

**Overall Dimensions**

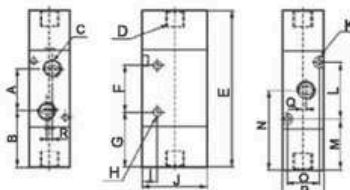
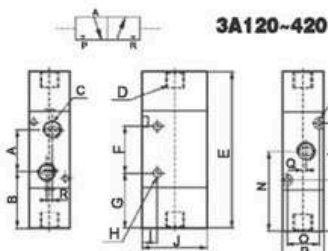

**Dimension Sheet**

Model	A	B	C	D	E	F	G	H	I	J	K	L	M	N	O	P	Q	R
3A120-M5	16	26.5	3-M5	G1/8"	69	21	24	2-φ3.3	7.7	27	2-φ3.3	19	12.5	34.5	13	18	/	/
3A120-06	16	26.5	3-G1/8"	G1/8"	69	21	24	2-φ3.3	7.7	27	2-φ3.3	19	12.5	34.5	13	18	1	2
3A220-06	22.5	35.5	3-G1/8"	2-G1/8"	84	25	29.5	2-φ3.3	8	35	2-φ3.2	30	27	45.5	17	22	1.5	/
3A220-08	22.5	35.5	3-G1/4"	2-G1/8"	84	25	29.5	2-φ3.3	8	35	2-φ3.3	30	27	45.5	17	22	1.5	3
3A320-08	24	36	3-G1/4"	2-G1/8"	96	30	33	2-φ4.3	10.5	40	2-φ4.3	35	30.5	48	20	27	/	/
3A320-10	24	36	3-G3/8"	2-G1/8"	96	30	33	2-φ4.3	10.5	40	2-φ4.3	35	30.5	48	20	27	/	/
3A420-15	31.5	39.5	3-G1/4"	2-G1/8"	/	51	/	2-φ4.3	11.5	50	2-φ4.3	/	/	55	27	34	2	/

## 4M Series Plate Type Valve



**4M310-10**



**4M210-08**



**4M220-08**

### Ordering Code

<b>4M</b>	<b>2</b>	<b>10</b>	—	<b>06</b>	—	<b>AC220V</b>	—	<b>W</b>
<b>Specification Code</b> 4M:Two(Three)-position Five-way Plate Type Valve	<b>Body Size</b> 2:1/8" and 1/4" Valve body 3:1/4" and 3/8" Valve body	<b>Coil and Places</b> 10:Single-head Double-position 20:Double-head Double-position		<b>Port Size</b> 06:G1/8" 08:G1/4" 10:G3/8"		<b>Standard Voltage</b> DC12V DC24V AC24V 50Hz/60Hz AC110V 50Hz/60Hz AC220V 50Hz/60Hz AC380V 50Hz/60Hz		<b>Wiring Form</b> Blank:standard Connector LD:Brown with Lighting Connector LD1:White with Lighting Connector W:Lead Wire Type

### Specification

Model	4M210-06	4M220-06	4M210-08	4M220-08	4M310-08	4M320-08	4M310-10	4M320-10
Working Medium	40 Micron Filtered Air							
Motion Pattern	Inner Guide Type							
Position and Way NO.	Two-position three-way							
Effective Section Area	14mm <sup>2</sup> (CV=0.78)		16mm <sup>2</sup> (CV=0.89)		25mm <sup>2</sup> (CV=1.39)		30mm <sup>2</sup> (CV=1.67)	
Port Size	Air Inlet=Exhaust=G1/8"		Air Inlet=G1/4"/Exhaust=G1/8"		Air Inlet=Exhaust=G1/4"		Air Inlet=G3/8"/Exhaust=G1/4"	
Lubricate	Not Necessary							
Working-Pressure	0.15~0.8MPa							
Max.Pressure Resistance	1.2MPa							
Operating Temperature	5~60°C							
Voltage Range	-15%~+10%							
Power Consumption	AC380V:2.5VA,AC220V:2.0VA,AC110V:2.5VA,AC24V:3.5VA,DC24V:3.0W,DC12V:2.5W							
Insulation & Protection Class	F Class.IP65							
Wiring Form	Connector type							
Highest Action Frequency	5 Cycle / Sec							
Shortest Excitation Time	0.05 Second							

**Overall Dimensions**

**4M210-06**

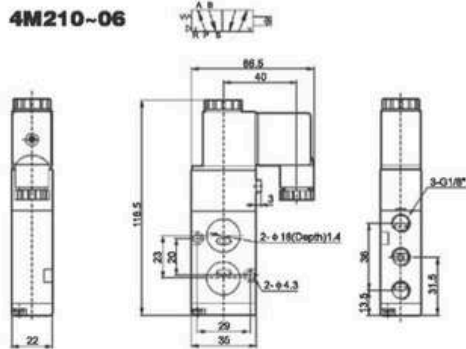

**4M210-08**

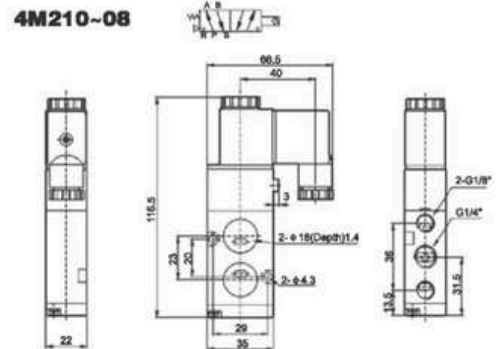

**4M220-06**

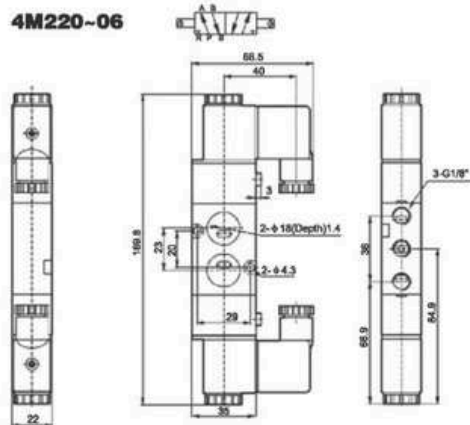

**4M220-08**

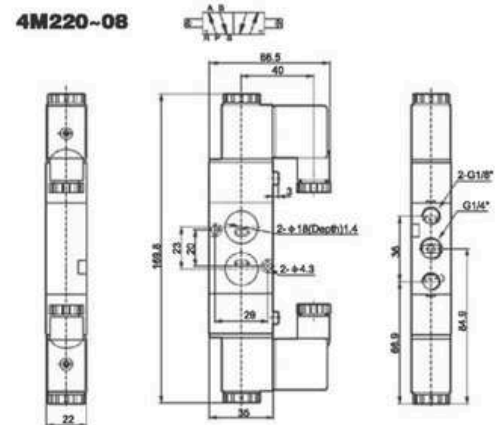

**4M310-08**

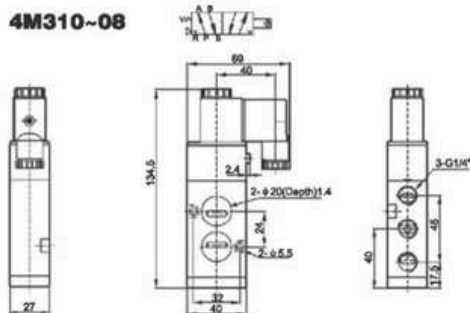

**4M310-10**

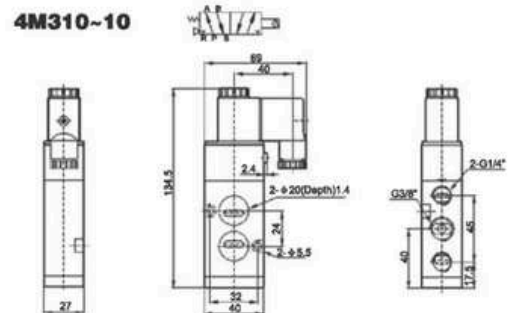

**4M320-08**

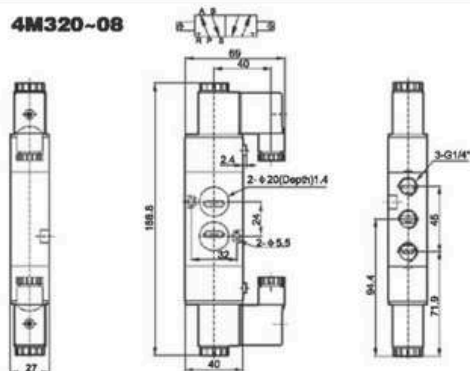

**4M320-10**

